



## M-Locks Alpha



AL2010



AL2020



AL2040



AL2050

### Technical Manual

AL2010 (Metal Housing-Chrome)  
AL2020 (ABS\* Housing-Chrome), AL2040 (ABS Housing-Brass),  
AL2050 (Metal Housing Gold plated)

### CHARACTERISTICS

Every key of the "soft touch"-keypad is angled so the lettering of the key is readable even if looking from above. The integrated battery compartment in the bottom of the Alpha entry unit opens by moving a slider. Cable length is approximately 30 cm.

### DIMENSIONS / MOUNTING INSTRUCTION

The diameter of the cable hole should be minimum 9 mm, maximum 12 mm.  
The hole must be de-burred well to avoid damage to the cable.

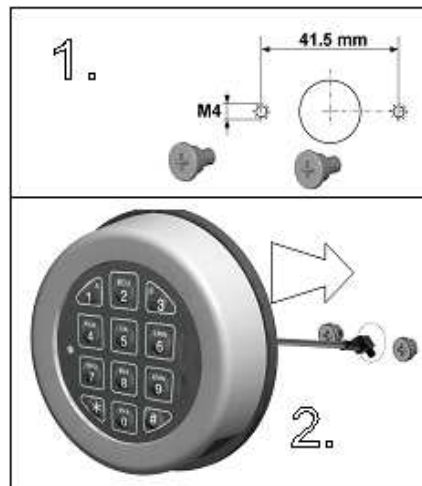
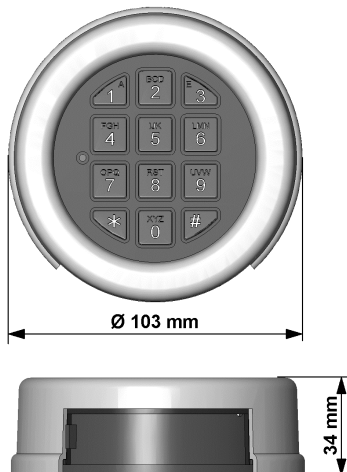

1. Affix the two mounting adapter screws (M4) hand tied.
2. Route the cable through the cable hole and slide the unit on the mounting adapters. Drill the screwheads so that tools don't work for dismounting (due to EN1300) and slide the unit on the mounting adapters in position 10:00 o'clock. Turn to 12:00 when fixing with pin.

In DNV approved applications the AL0005 spy-proof cover must be fitted and a seal must be fitted between safe door and keypad housing.

### The Alpha 1 entry unit can now not be removed!

Connect one (1) battery to the battery clip. Only use new 9V ALKALINE Duracell/ Procell (or Energizer) batteries.

*This mounting instruction is part of VdS certification and has to be followed up precisely.*

\*Acrylonitrile butadiene styrene, or ABS, (chemical formula  $C_8H_8 \cdot C_4H_6 \cdot C_3H_3N$ ) is a common thermoplastic used to make rigid, moulded products.